



STRETCH

STRETCH, The ideal solution
for the decoration or renovation
of your spaces

Introduction

This technical guide for installing STRETCH ceiling coverings and profiles has been exclusively created for fitters in the STRETCH network who have successfully completed STRETCH's approved fitter training programme.

It must not be used in place of the training given at the STRETCH premises (state-approved training) and must not be made available to third parties.

This workbook is designed to provide a complement to training, revisiting and developing the subjects covered during the programme

A copy of this guide shall be issued to each participant at the end of the two-day training programme carried out in our premises in Beveren (Belgium).

General information

Introducing the STRETCH ceiling system

The STRETCH ceiling system features two main elements:

- PVC-free STRETCH ceiling coverings, in polyurethane-coated polyester mesh.
- Peripheral fastening profiles into which the covering is clipped using a special kind of spatula.
- The quick, efficient STRETCH ceiling installation system, carried out at room temperature, meets various requirements, and can satisfy all kinds of design and decoration ideas.

It is perfectly suitable for new build or renovation work, and for use in the home as well as professional environments.



Advantages of the STRETCH ceiling system

STRETCH ceiling coverings

- STRETCH ceiling coverings are available in extra-wide sizes (net usable widths of up to 5.1 m).
- 10-year guarantee.
- The PVC-free STRETCH ceiling coverings hold an ecolabel and A+ labelling, and comply with EC standards.
- The factory, located in France, using European raw materials, is certified ISO 9001 (you can find all of the standards and certifications held by STRETCH ceiling coverings on our website at www.stretchgroup.net).
- STRETCH ceiling coverings are water repellent and chlorine resistant.
- They can be washed using a pH-neutral cleaning product.
- Some can be painted (using acrylic paint).
- The coverings are much more resistant than PVC.
- STRETCH ceiling coverings are highly stable at room temperature.
- They can adapt to all shapes.

Installation

- Quick and simple measurements enable you to create instant quotes
- Quick, dry, odourless and waste-free installation at room temperature
- Installation in one session, with no resulting nuisance
- Furniture does not need to be moved. The interior space isn't turned into a building site for days on end

The specific equipment required

The STRETCH ceiling system requires minimum investment in terms of tools and equipment. Certain essential tools must be used in order to ensure that a high-quality installation is achieved. They complement the standard tools in any craftsman's collection (screw gun, drill, level, tape measure etc.).

They include:

- 1x putty knife (ref. O-CTM & O-CTI) (*)
- 1x mitre-cutting shears (ref. O-SLHU)
- 1x snap-off blade utility knife (ref. O-C20E) (*)



Spatula
Ref O-CTM



Special spatula for
corners
Ref O-CTI



Mitre-cutting shears
Ref O-SLHU



Snap-off blade utility
knife
Ref O-C20E

(*) These tools are included in the cost of the training and will be provided at the end of the session. The detailed characteristics of the putty knife are listed in our pricelists.

N.B.: In its price list, STRETCH offers a complete toolbox, including essential tools along with the recommended equipment for fitters.

The result

- The STRETCH ceiling system is the perfect solution both for renovations and for new buildings. It can fulfil all constraints and styles, and can be fitted on to any type of substrate.
- The stretching system and the high-tech nature of STRETCH ceiling coverings guarantee complete uniformity and a perfectly smooth surface
- The system also enables easy incorporation of downlighters, light fittings and all types of decorative or technical elements
- STRETCH ceiling walls and ceilings improve aesthetic and acoustic harmony.



Basic principles

Preparation of the worksite

To ensure the best possible conditions for your installation, preparation of the worksite is essential.

Following a quick assessment of the site at your customer's premises, in a single session, you will produce a quote following the 6 main steps:

1. Identify and analyse the **customer's request** (e.g. specific aesthetic requirements, acoustics, incorporation of light fittings etc.).
2. Identify the **type of substrate** upon which the covering will be installed.
3. **Choose the fastening system** for the covering and the relevant profiles.
4. **Analyse the constraints of the premises** (depending on their configuration and the type of environment).
 - Humidity, room temperature, potential heat sources, fire reaction regulations, acoustic requirements.
 - Height, corners, double joins etc.**Analyse technical constraints such as:**
 - Wall and ceiling air/water-tightness: no entry of air.
 - Check that the walls and/or ceilings are sound: no humidity.
5. **Take measurements** using a standard tape measure or a laser.

To calculate the quote, simply take the **maximum length** and the **maximum width**, add a technical margin of 100 to 200 mm depending on the size of the ceiling/wall or its technical nature.

In order to determine the correct quantity of profiles needed, we strongly recommend to use the following formula: Perimeter + 10 %.

Example:

Your ceiling or wall measures 2.4 m x 4.0 m.

You should therefore order a fabric measuring 2.6 x 4.2 m and profiles 6 m + 8 m long.

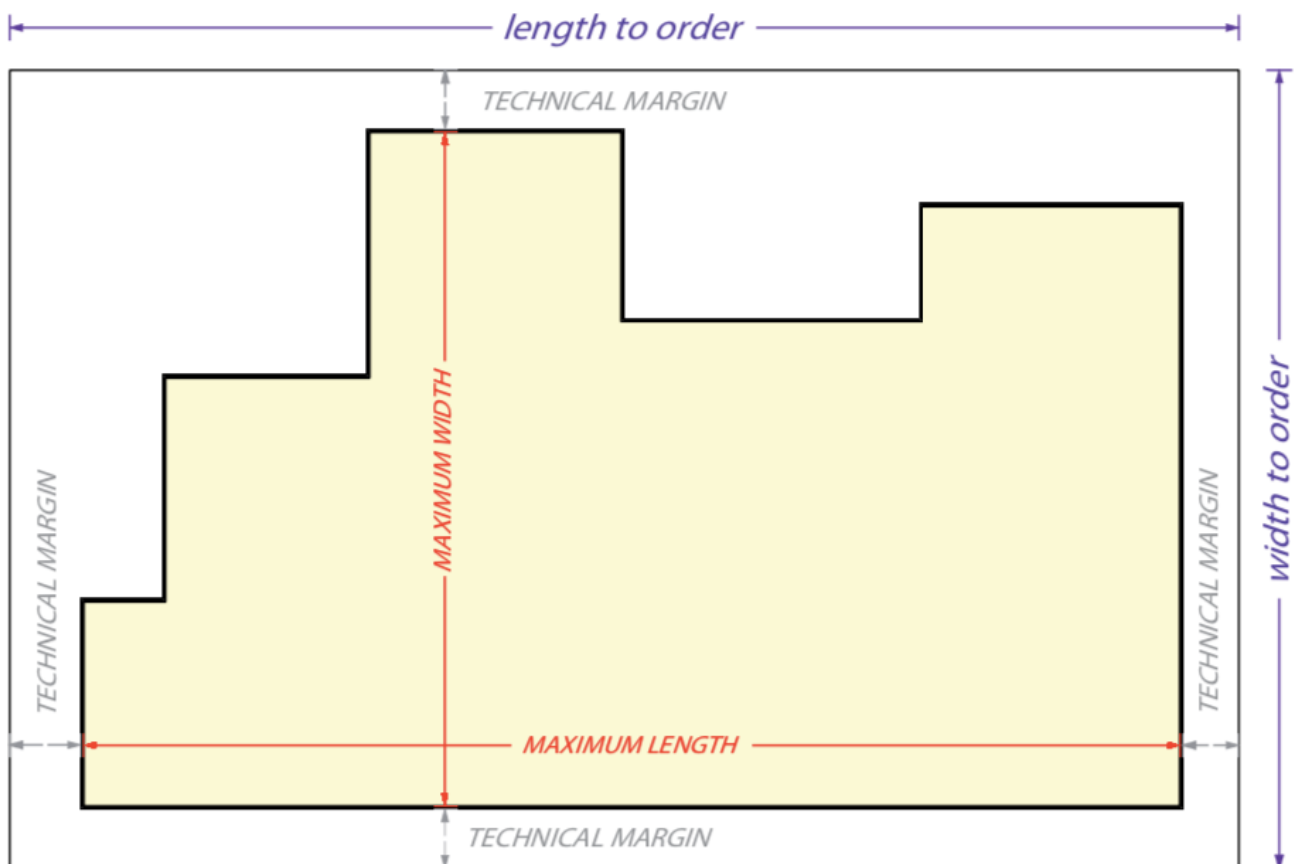

CAUTION

If the length of your ceiling or wall is greater than 5 m, we recommend adding a 20 cm margin.

For example - if you have taken the following measurements: 4.9 x 5.5 m. You should order a fabric measuring: 5.1 m x 5.9 m.

Then all you have to do is prepare your quote using the price list and the total number of m2 established in your calculations.

The system is very easy to follow, and can be easily explained on site to your customer, who may even end up signing your order there.

From the assessments made on site, fill out the purchase order provided by STRETCH following the template below (which you can request from the sales department at: info@stretchgroup.be)

Your order can be sent by e-mail to the orders and transport department at: order@stretchgroup.be or it is also possible to do your order directly online through our online webshop.

Purchase orders:

STRETCH

Date : Your salesman:

Request for quote to quote@stretchgroup.be
Order to order@stretchgroup.be

Desired delivery date:
order)

Priority processing (50€ fixed rate per order)

Your billing address			Your delivery address (if different)				
Company name		Company name					
Address		Address					
ZIP / City		ZIP / City					
Country		Country					
Phone		Phone					
Responsible		Responsible					
Type of transport desired (please tick the appropriate box)							
Road transport							
						Your signature and stamp:	
CLIPSO ARTICLE REFERENCE No	DESIGNATIO N (Coverings, profiles, spots, tools, etc...)	COLOR	QUANTITY		LENGTH Margins included	WIDTH Margins included	YOUR COMMENTS
			lm	unit	in mm	in mm	
7055	Covering	0001			3100	4000	
P-CC	Profile	White	2	8			
O-CTM	Spatule			1			
O-SLHU	Gear down mitter			1			
O-C20E	Joint cutter			1			

By placing this order, you accept our general terms, which you are aware of. Prices, conditions, date of delivery and payment are mentioned on our confirmation orders and invoices. Normal order processing: 72 hours (Exworks) provided that your order is complete (references, description, quantities ...- see pricelists); except if you have ticked the boxes EXPRESS DELIVERY and/or PRIORITY PROCESSING.

STRETCH BVBA - Gentseweg 309 D4 - 9120 Beveren-waas - Belgium - Tel. : +32485483035 - VAT No: BE 0675.875.709
www.stretchgroup.net - info@stretchgroup.be

The orders and transport department will inform you (by e-mail or telephone) of the shipping date off your products.

Receiving your products

1. Open out the packaging.
2. Cut open the packaging carefully using scissors, taking care not to nick the covering.
3. Wear gloves to protect the covering from dirt.
4. Identify the front side of the covering, to which a sheet of paper is attached.
5. Remember to cut out the guarantee label located on the packaging and keep it in a secure place.
6. This label MUST be kept in your customer's invoice file. Staple the guarantee label located on the packaging.



PRECAUTIONS

Several very simple precautions should be taken to ensure that the fabric is kept in the best possible conditions:

- If, upon receiving the products, you notice that the protective box and/or packaging is damaged, this must be immediately noted on the transporter's delivery slip; no claims concerning the guarantee can be handled unless this has been noted.
- STRETCH ceiling coverings must always be stored in their protective covers (always try to leave the package unopened until the last possible moment, just before installation).
- Coverings delivered on rolls must be stored flat and not on their end, even during transport (please check this upon delivery).
- Remember to store STRETCH ceiling coverings in a room where the room temperature is no lower than 0°C and no higher than 40°C.
- The environment MUST be clean.
- Do not place anything on top of the packages.
- Gloves MUST be worn to install the fabric.

The installation method

Ceilings

Choosing profiles

When installing a STRETCH ceiling covering, the suitable profiles shall be selected depending on the type of surface and application chosen.

In all cases, installation complies with the NF DTU 58.2 P1-2 and DTU 59.4 standard.

Hard surface

i.e. concrete, brickwork:

the recommended profile is **P-CC** fitted on battens.

Fixing system:

Dowels and wood screws fastened to the profile every 10 cm.

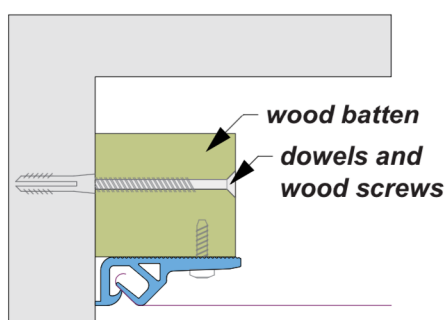

Picture of P-CC profiles fixed onto a hard surface.

Soft surface

i.e. wood, plaster blocks or plasterboard:
the recommended profiles are **P-CC** or **P-CW**.

Fixing system:

glue, staple or screw,
or wood screws fastened every 10 cm.

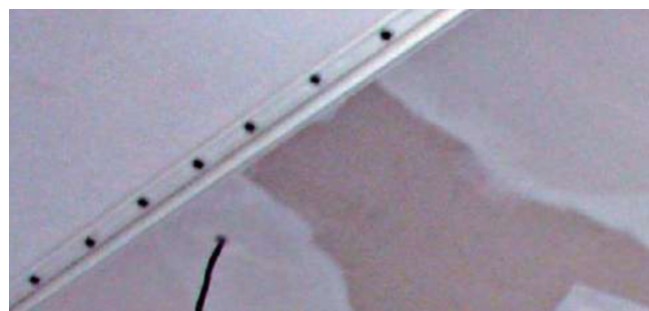
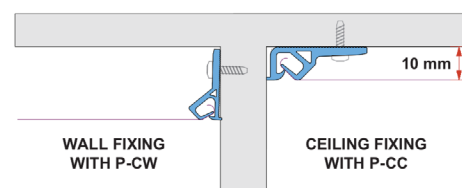

Picture of P-CC profiles fixed onto a soft surface.

All the recommended screws and dowels can be found in the STRETCH pricelist.

Installing profiles

The application method is also related to the installation selected, i.e. with or without plenum.

Ceiling without plenum (distance of at least 12 mm between the fabric and the surface)

Profiles recommended for this type of application:

P-CC / P- CB022 / P-CCA.

- Cut the profiles to the correct length. For the corners, make angled cuts using the shears (ref. O-SLHU) or a mitre saw.
- Fit profiles around the existing ceiling (see the DTU 58.2 P1-2 standard) using fixing systems to suit the type of surface and technical constraints, and taking the above indications into account.

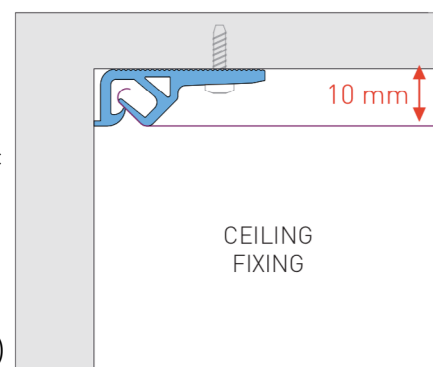

N.B.:

The profiles must be fixed at their join.

Profiles must not be deformed by incorrect fixing or a highly stretched covering.

In the case of the profile being stapled, the use of divergent staples is recommended.

Ceiling with plenum

Profiles recommended for this type of application:

P-CW / P-CWA / P-CC / P-CCR.

- Cut the profiles to the correct length.
For the corners, make angled cuts using the shears (ref. O-SLHU) or a mitre saw.
- Using a laser level or classic level, determine the level at which the profiles are to be fitted around the wall (taking into account the light fittings and other technical elements to be installed).
- Fit profiles around the existing wall (see the DTU 58.2 P1-2 standard) using fixing systems to suit the type of surface and technical constraints, and taking the above indications into account.

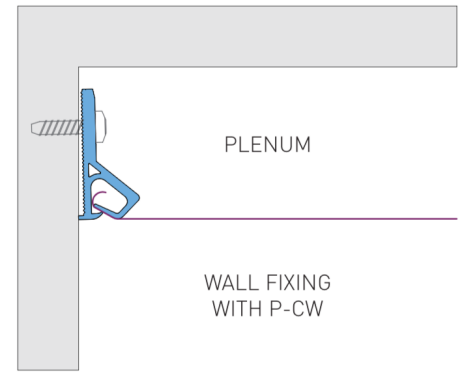

N.B.:

The profiles must be fixed where they join.

Profiles must not be deformed by incorrect fixing or a highly stretched covering.

In the case of the profile being stapled, the use of divergent staples is recommended.

Overview of corner cutting

The geared mitre-cutting shears (ref. O-SLHU) is a tool specifically designed for cutting the profiles and obtaining perfect finishes on internal and external corners.

In addition, this tool has the advantage of having very small dimensions and is easy to handle.



You can, of course, achieve very good results with a mitre saw, but this tool is more difficult to transport.

Fitting the covering

Make sure you wear gloves when carrying out this operation (see STRETCH price list).
For dark fabrics, the use of cotton gloves is recommended (see STRETCH price list).
We also recommend that you use a knife with a new blade for a high-quality cut.

The STRETCH putty knife is the essential tool for installing coverings, regardless of the type of application. Overview of the O-CTM putty knife

In order to use the putty knife (ref. O-CTM) you need to know the following specific points, given during the training programme.



- The corner (1) is used to fit the covering into the profile whilst moving forwards to the rounded edge (2)
 - The point of the putty knife (3) is used for making angles. It is recommended that the point of the putty knife is only used in corners, as it could tear the fabric.
- It is important that you work with the putty knife held inclined at 45°.

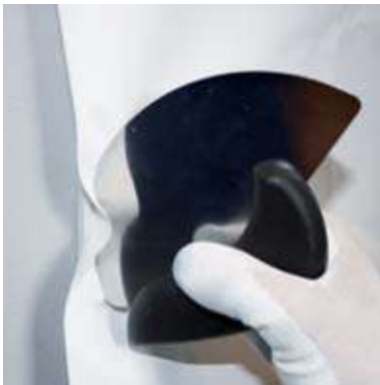

Positioning of the putty knife.



Clipping the covering into the profile.



Work angle of 45°.

The covering is installed in several consecutive stages, the order of which must be respected in order to ensure a perfect finish in accordance with workmanship principles.

1. Positioning the covering

- Make fixing points every 500 mm as shown in the diagrams below.
- Make sure to work with opposite corners.
- Take geometry into account and start with the largest surfaces.

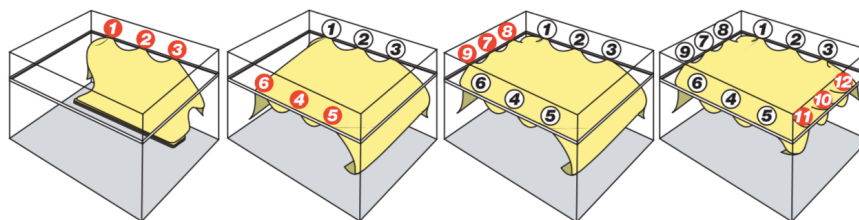

2. Stretching the covering

- Return to the different points in the order indicated, and always work with opposite corners.
- Always start at the centre and finish in the corners.

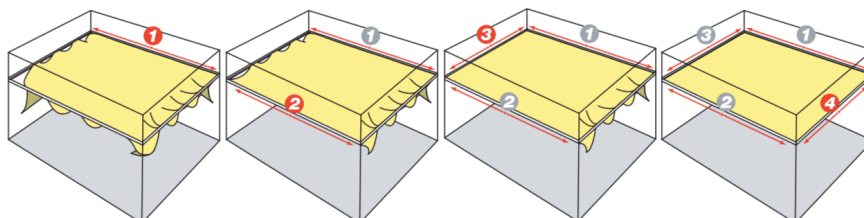

3. “Closing off” the covering

• Clip the covering into the recess in the profile. The mechanics of the profile will ensure perfect stretching. The aim of this very important operation is to get rid of surplus material.

4. Finish

- Ensure that step 3 was completed without leaving openings between points.
- Cut off the surplus material, making sure to leave 10 mm of fabric after the profile. To do this, we recommend using the utility knife (O-C20E)
- Using your putty knife, press the covering into the profiles.
- Use the heat gun to remove any minor imperfections.

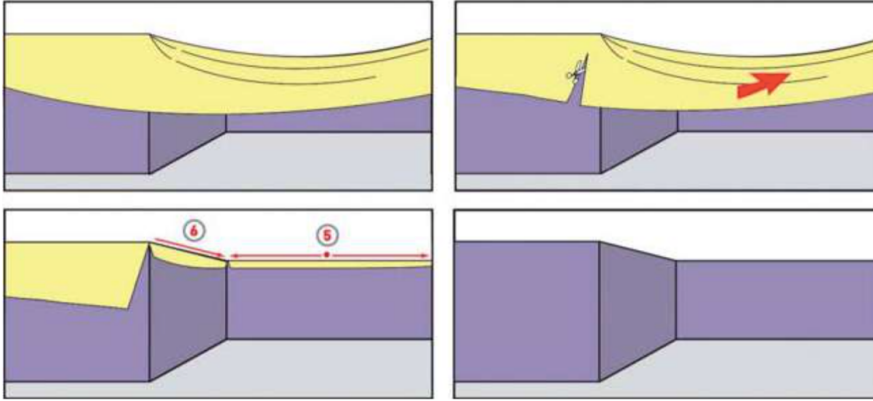

N.B.:

In order to avoid damaging or weakening the profile, never use the utility knife directly in the profile recess.

Heat gun operating principle.



In all cases, we invite you to refer to your device's operating manual and to the manufacturer's instructions.

In order to achieve a perfect result, the heat gun must be held approximately 100 to 150 mm from the fabric. The heat source must in no event come into direct contact with the fabric. Use regular back-and-forth movements until any creases disappear. The covering's heat-shrinking principle will work faultlessly to achieve a perfect finish.

CAUTION

During this operation, the profile must be protected from heat using the putty knife.

Closing off corners:

Closing off external and internal corners requires very careful attention due to the stretching and the cutting operation.

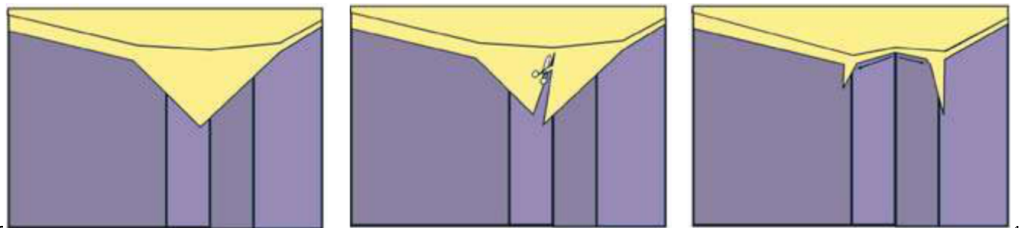

30 mm from the corner, carefully press the excess covering into the recess using the putty knife, pushing gradually from the bottom to the top.



PRECAUTIONS

The external corners are to be worked on last, after the “closing off” operation has been carried out. The internal corners are to be worked on at the same time as the closure operation.

If required, the heat-shrinking operation should be carried out once the finish is complete.

It is essential to pay particular attention to areas where the covering is not supported (e.g. around pipes, etc.).

Ceiling with a complex shape

For complex-shaped rooms, the largest surfaces must be covered first, and the operation should be carried out as if there were two separate ceilings, surface A and surface B.

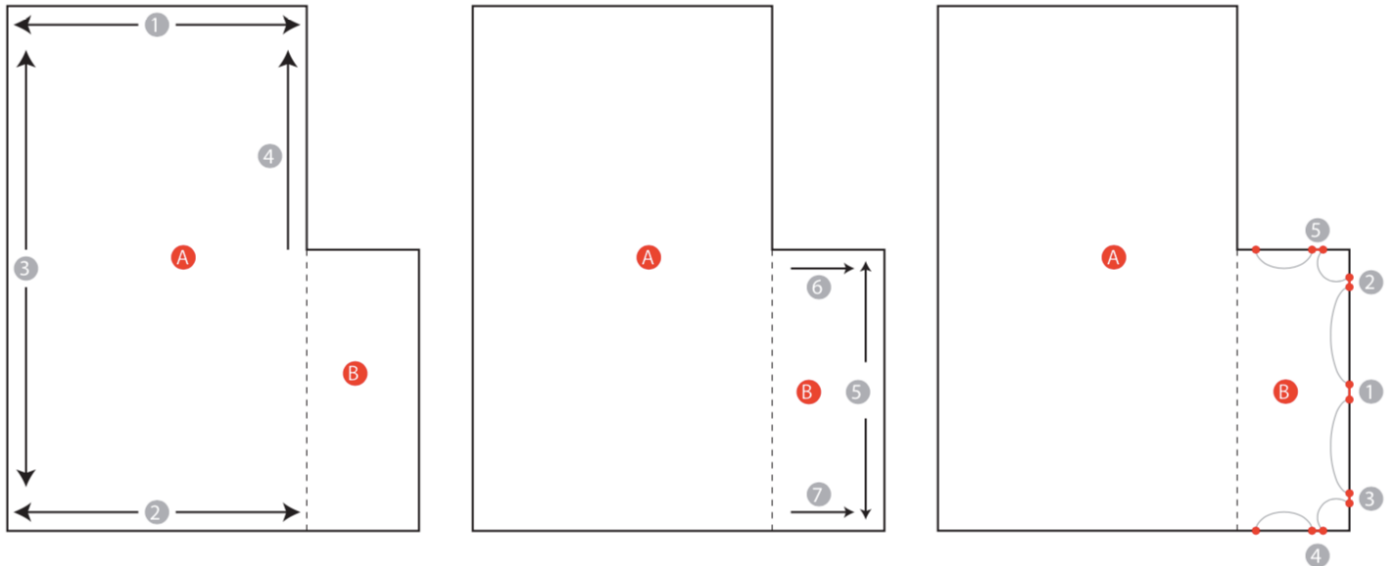

• When changing from surface A to surface B, the covering must be cut at the internal corner in order to allow the installation of surface B.

• The principle behind cutting in the corner is the same as for fitting a carpet.

Very large ceilings, double join principle.

For rooms wider than 5 m, a join must be created, carefully dividing up the room.

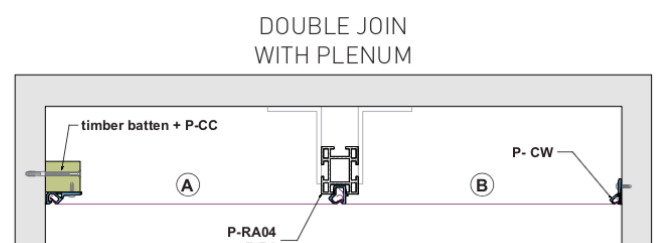
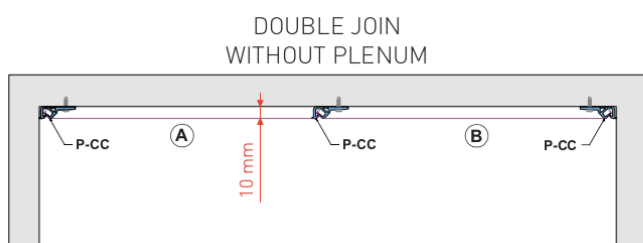
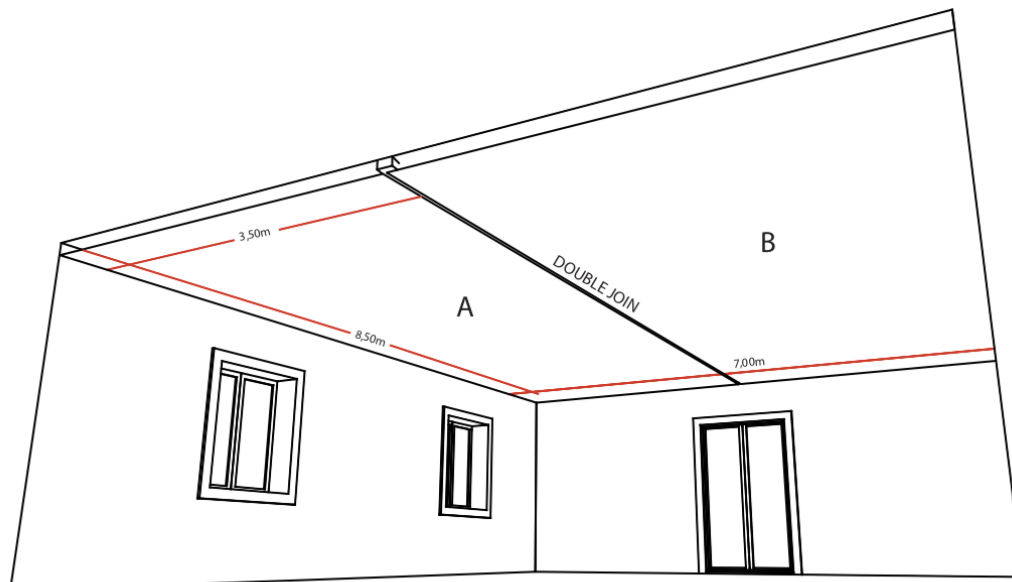

Proceed in the following manner:

- Fix the suitable profiles: P-CC or P-RA04 at the place where you wish to make the join.
- Create a nick as shown in the sketch below.
- Install ceiling A and ensure that it is fully completed.
- Then install ceiling B following the same process.
- Use heat-shrinking if necessary, and complete the finish.



CAUTION

When installing with a double join, the only suitable profiles are the P-CC, or the P-R04 used with a P-B1.

For this type of configuration, it is essential to match the direction of the covering's weave, which must be from the same production batch. This information MUST be displayed on the purchase order you issue.

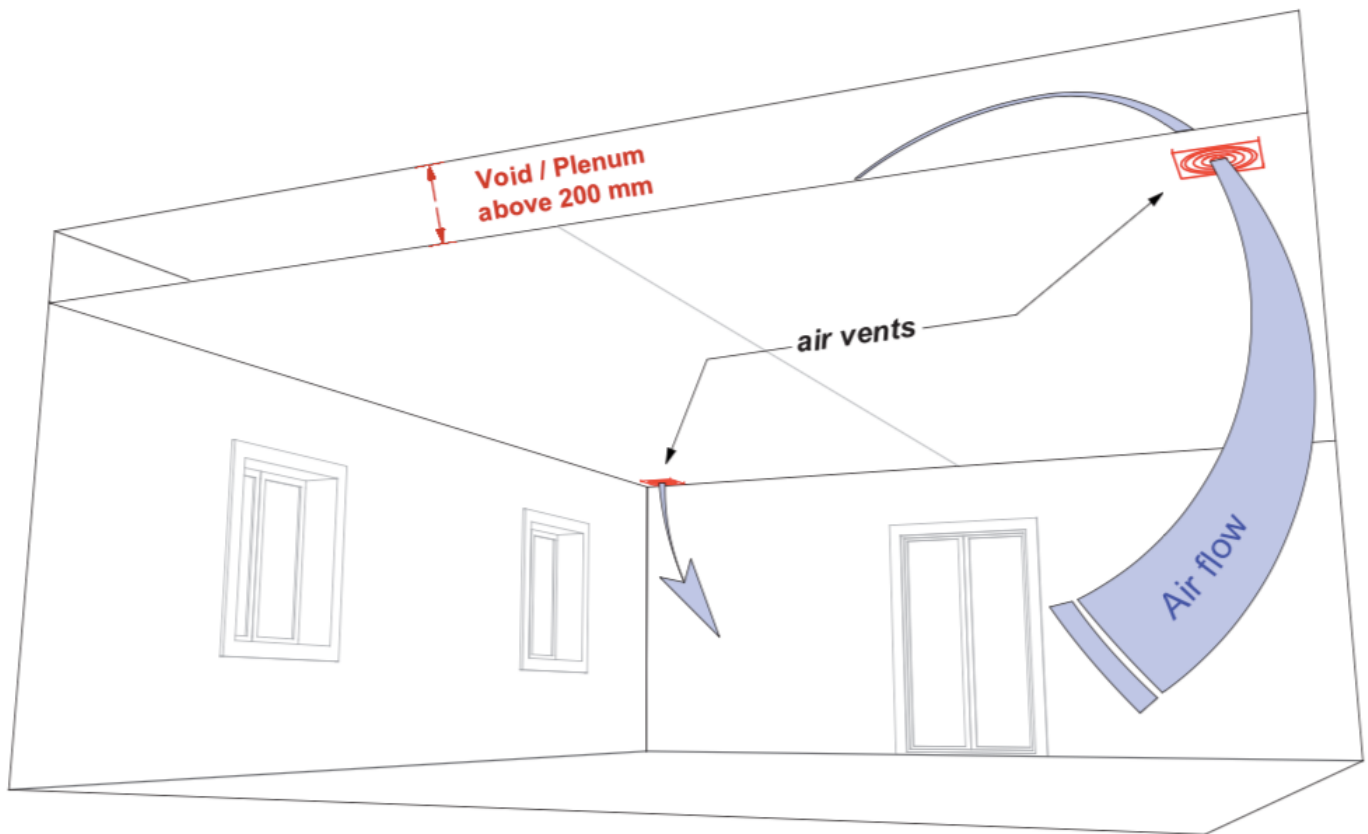

CAUTION

For ceilings installed in large rooms (greater than 40 m²) and/or with a large plenum (greater than 30 cm) or with air extraction devices or ventilation hoods, and to avoid “flapping” effects, air vents should be planned at opposite corners of the room.

This will allow air to circulate between the plenum and the room, avoiding “flapping”.

Installation of light fittings, technical elements and other specific elements is covered in the detailed technical data sheets (from page 24 onwards).

Walls

Choosing profiles

When installing a CLIPSO wall covering, the suitable profiles shall be selected depending on the type of surface and application chosen.

In all cases, installation complies with the NF DTU 58.2 P1-2 and DTU 59.4 standard.

Hard surface

i.e. concrete, brickwork:

the recommended profiles are **P- CC**, **P-CCA** or **P-C6**.

Fixing system:

dowel + screw

or dowel + nail fastened to the profile every 100 mm.



Picture of P-CC profiles fixed onto a hard surface.

Soft surface

i.e. wood, plaster blocks or plasterboard:

the recommended profiles are **P-CC**, **P-CCA** or **P-C6**.

Fixing system:

glue, staple or screw,

or plaster screws fastened to the profile every 100 mm.

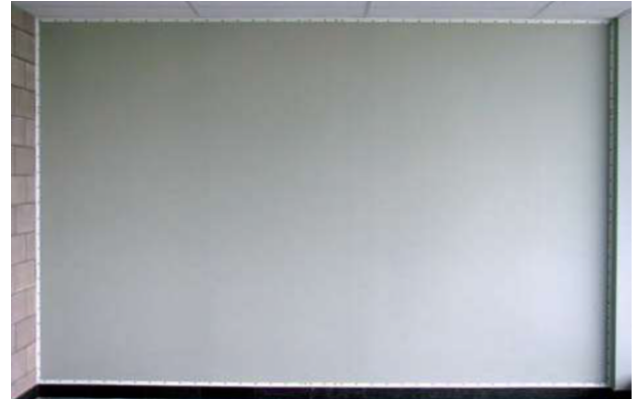

Picture of P-CC profiles fixed onto a soft surface.

Installing profiles

The requirements for preparing the support are considerably less strict than for an adhesive mounted covering. Nevertheless, care must be taken to block off any air flow, fissures and joints, to avoid any risk of staining the wall covering and to prevent any significant surface irregularities.

Profiles recommended for this type of application: P-CC / P-CCA / P-C6.

- Cut the profiles to the correct length.

For the corners, make angled cuts using the shears (ref. O-SL-HU) or a mitre saw.

- Fit profiles around the existing wall (see the DTU 58.2 P1-2 standard) using fixing systems to suit the type of surface, technical constraints, and the above-mentioned indications.

- Fit profiles around the existing doors and windows (see the DTU 58.2 P1-2 standard)

- For light switches and sockets, a spacer approx. 10 mm thick must be installed.

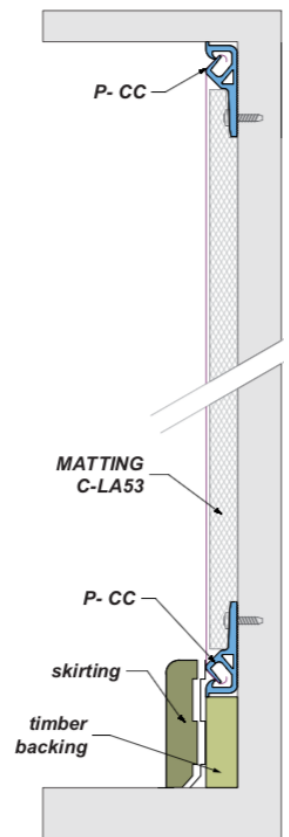

N.B.: The profiles must be fixed where they join.

Profiles must not be deformed by incorrect fixing or a highly stretched covering.

In the case of the profile being stapled, the use of divergent staples is recommended in order to provide increased resistance to tear-out.

IMPORTANT PRECAUTION

We strongly recommend that you fasten profiles to the top of skirtings. Fitting wall coverings right to the floor surface can result in damage in the event of repeated impacts when vacuuming, cleaning, etc.).



To improve the room's acoustic comfort, noise insulation fabric can be fitted (ref. C-LA 53). Among other advantages, this fabric ensures a perfectly flat wall surface and is pleasant to touch.

Please respect the manufacturer's instructions for your chosen noise insulation fabric. Remember to place your fabric against the profiles to avoid any unattractive shadows at the fabric/profile join.

There are various methods for fixing your chosen noise insulation fabric or acoustic absorbent: either stapling or a suitable adhesive can be used, or even double-sided adhesive tape.

PRECAUTION

Make sure the profile is not covered by the matting.

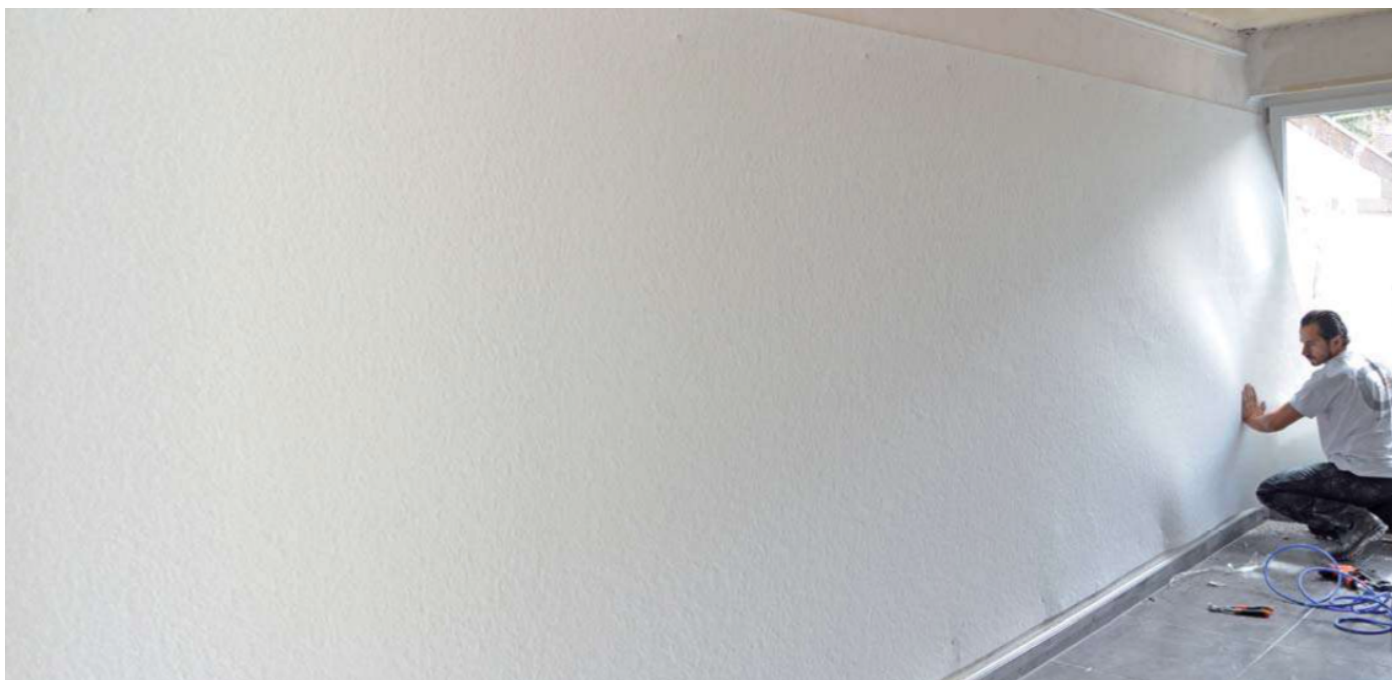

Fitting the covering

Installing coverings for stretch walls follows the same process as for stretch ceilings. The covering is installed in several consecutive stages, the order of which must be respected in order to ensure a perfect finish in accordance with workmanship principles.

1. Positioning the covering

- Make fixing points every 500 mm as shown in the diagrams below. • Make sure to work with opposite sides.
- Take geometry into account and start with the largest surfaces.

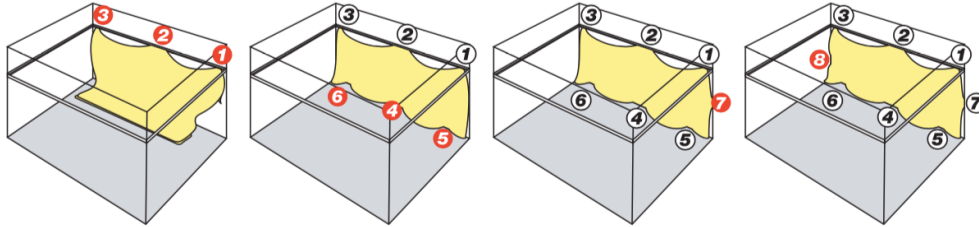

2. Stretching the covering

- Return to the different points in the order indicated, and always work with opposite sides. • Always start at the centre and finish in the corners.

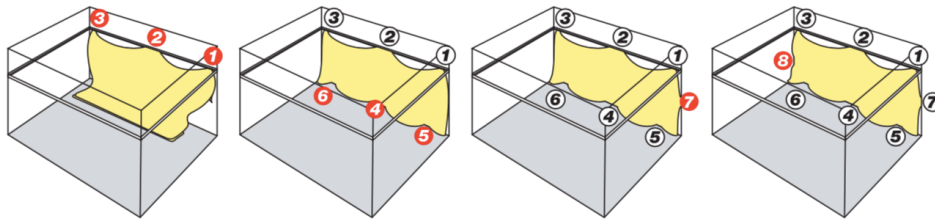

3. "Closing off" the covering

- Clip the covering into the recess in the profile. The mechanics of the covering will ensure perfect stretching. The aim of this very important operation is to get rid of surplus material.

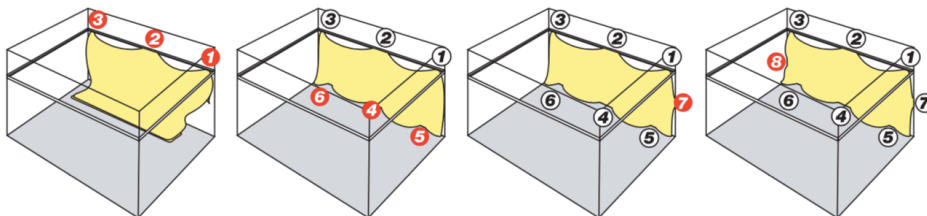

4. Finish

- Ensure that step 3 was completed without leaving openings between points.
- Cut off the surplus material, making sure to leave 10 mm of fabric after the profile. To do this, we recommend using the utility knife (O-C20E).
- Using your spatula, press the covering into the profiles.
- Use heat-shrinkage to remove any minor imperfections.



CAUTION

In order to avoid damaging or weakening the profile, never use the utility knife directly in the profile recess.

Working around doors and windows or switches and sockets



Make knicks in the covering.



Cut open the window space.



Cut off the excess.



Press in the remaining excess.

Ouverture

1. Find the profiles using the spatula.
2. Apply pressure to hold the covering in place.
3. Make cuts in the covering (see images). Repeat the operation approx. every 300 mm all around the opening.
4. Cut out the opening following the cuts, making sure to leave a margin of 10 to 15 mm.
5. Press the covering into the profiles following the above-mentioned method. Pay particular attention to corners.

Finish

6. Clip the surplus covering into the profile.
 7. Cut out the corners (see page 22 for details).
 8. Use heat-shrinkage to remove imperfections (see page 22 for details).
- any

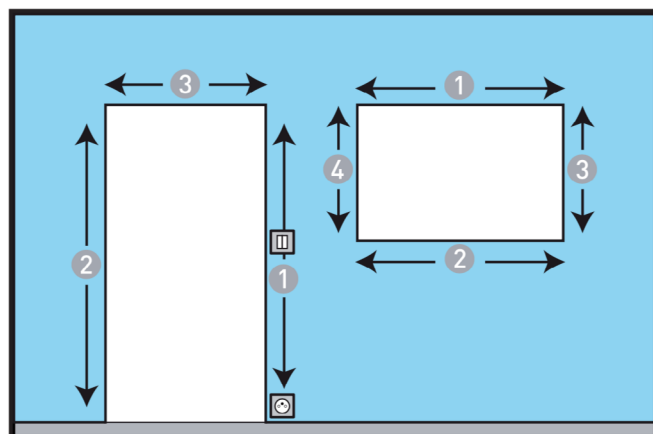
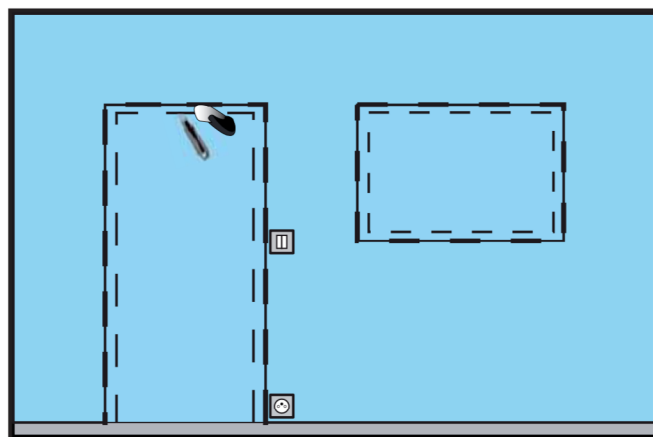

Close-up of creating a nick



Find the profile.



Make knicks in the covering.



Clip the covering.

Close-up of cutting out a corner



Find the corner.



Cut into the covering.



Clip the covering.

Close-up of creating a nick



Find imperfections.



Use the heat gun.



Observe the result.

Close-up of creating a nick



Find the switch.



Cut into the covering.



Fit the cover.

Wall and ceiling joints

When installing CLIPSO coverings on the wall and ceiling of the same room, the profiles can be joined together.

Two profile fastening methods can be used to complete this operation:

1. A P-CC profile fixed to the wall to stretch the wall covering, and a P-CW to stretch the ceiling covering.
2. For a high-quality, invisible finish, we will use a P-CC profile fixed either to the wall or to the ceiling, into which both coverings can be clipped. For this method, it is easier to fix the P-CC profile to the wall.



Trim the covering over the entire length using a utility knife.



For corners, use a utility knife to remove the rest of the covering.



Press the covering's excess margin into the recess in the profile.

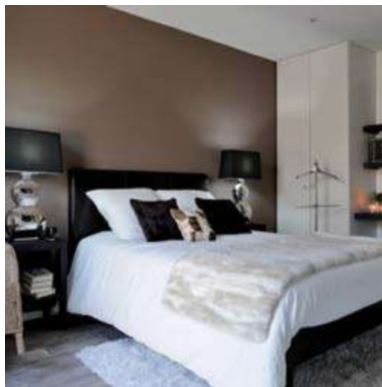

Orders for large projects

For large-scale projects (minimum 100 m²), we advise that you inform your sales representative of the products and the total quantity of coverings required for the entire project when placing your order. CLIPSO will make sure to supply fabric from the same production batch throughout the duration of your project, even if you place orders at several stages. Make sure that you specify the project reference number when ordering, and consider ordering an extra quantity of fabric in case you subsequently require after-sales service.



CASE 1

Incorporating spotlights



Incorporating spotlights of various sizes and types is quick and easy.

You need to follow three main steps:

1. Levelling off

Once the profiles are fixed in place, stretch a piece of string from one profile recess to another using the putty knife, in order to ensure that all lights are levelled.

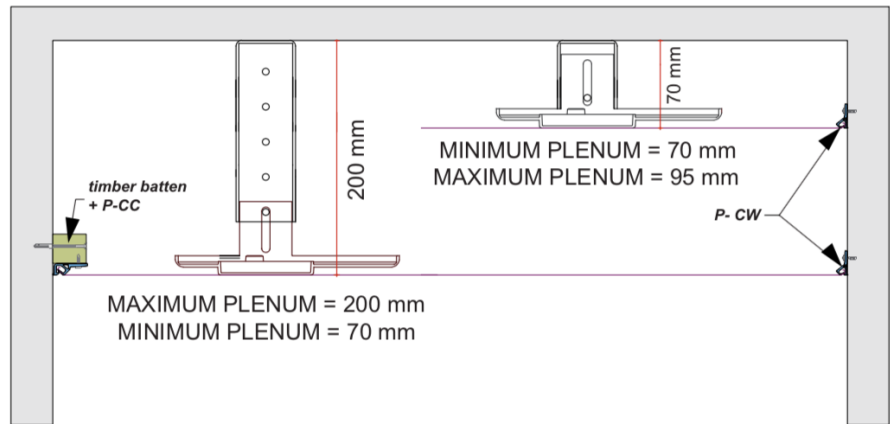

2. Installing supports

Then fix the different supports (spotlight holder, hatches, spacers, etc.) up against the string.

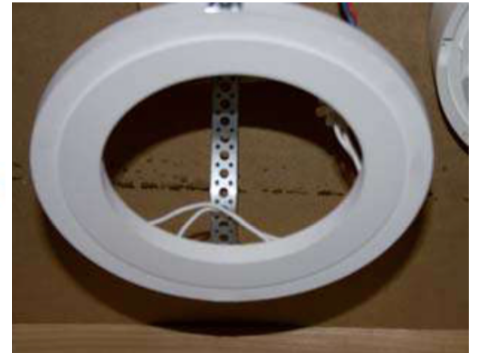

3. Connecting a spotlight holder

Once the covering has been stretched, locate the spotlight holder and cut out a star shape (1). Then retrieve the cable (2) from the spotlight holder and connect the spotlight (3).

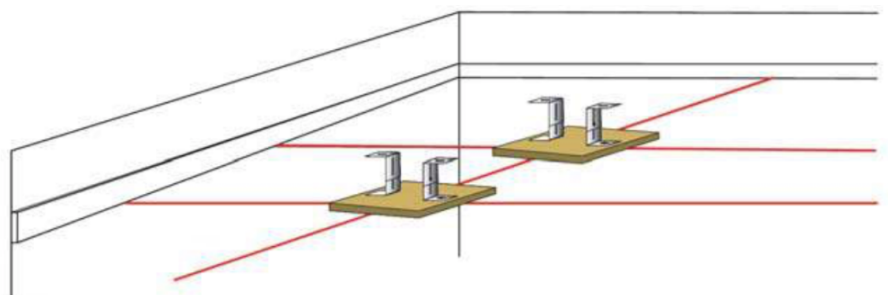

CASE 2

Incorporating light fittings chandeliers and pendant lights



Incorporating light fittings such as chandeliers and suspended lights requires little preparation and is easy to achieve.

1. Preparing the surface

Depending on the installation method chosen (with or without plenum): once the profiles are fixed in place, stretch a piece of string from one profile recess to another using the putty knife, in order to ensure that all lights are levelled.

2. Installing supports

Fix the different supports (hatches, spacers, etc.) up against the string.



timber backing

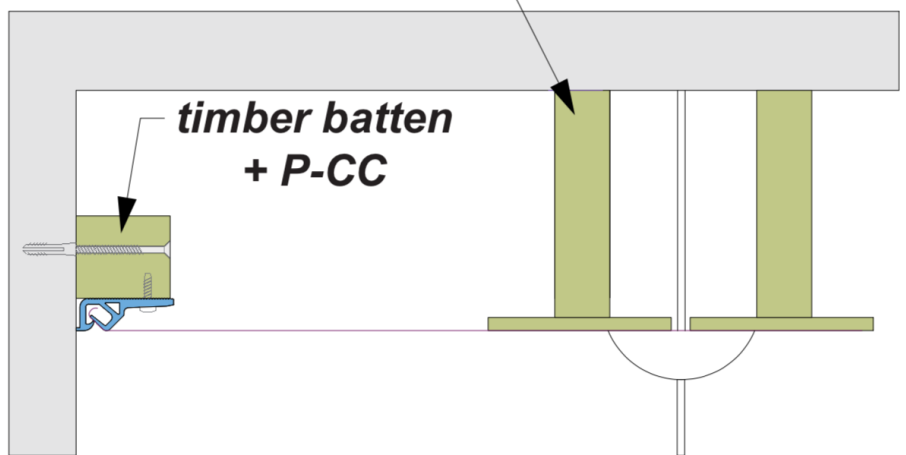

3. Connecting a chandelier or suspended light

Once the covering has been stretched, find the location of the light's cable, retrieve the cable and connect the spotlight.

P-CC

timber backing



CAUTION

In the case of a room with ceiling fans: It is important to ensure that the covering is correctly stretched to avoid any ceiling flapping. Make sure that you leave a minimum distance of 500 mm between the blades and the ceiling.

STRETCH

STRETCH BVBA
Gentseweg 309/D4
9120 Beveren-Waas
Belgium

Tel.: +32485483035

E-mail: info@stretchgroup.be
Web: www.stretchgroup.net